

Bring this booklet to your child's appointments.

ISENTRESS (raltegravir)
for oral suspension

Instructions for Use

for babies and toddlers

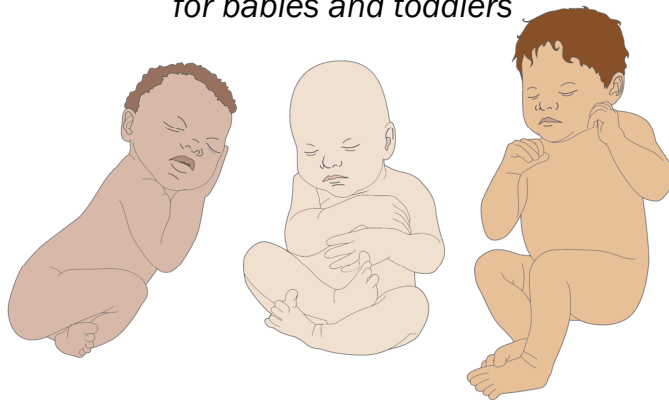

Before You Start

Note: Make sure your doctor shows you how to prepare and give ISENTRESS for oral suspension.

- Be sure you understand these instructions before you start. Call your doctor if you have any questions.
- It is very important that you measure the water and ISENTRESS carefully using the correct syringe.
- Before you give ISENTRESS to your child, check the expiration date. The expiration date is printed on the box and the ISENTRESS packets.
- Do not open the ISENTRESS packets until you are ready to mix a dose.

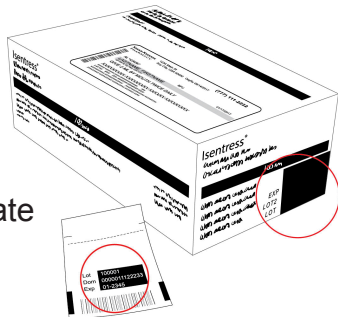

Before You Start

- The amount of ISENTRESS depends on your child's age and weight, so it will change over time.

Your doctor will tell you the right dose at each check-up after weighing your child.

Be sure to keep your doctor's appointments so you get new dosing information as your child grows.

During your child's first week of life, you will give ISENTRESS 1 time a day. After the first week of life, you will give it 2 times a day.

- This booklet tells you how to:
 - Mix ISENTRESS into a liquid form
 - Measure the right dose using a syringe
 - Give ~~mixed~~ ISENTRESS to your child
 - Clean up

Kit Contents

- Prescription (on box)
- Instructions for Use (this booklet)
- Prescribing Information
- 6 syringes

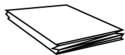

- 2 mixing cups
- 60 packets of ISENTRESS

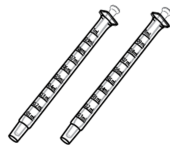
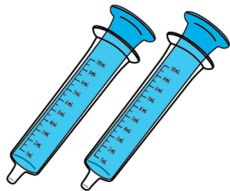

2 **blue** (10mL) syringes 2 **green** (3mL) syringes 2 **white** (1mL) syringes

The kit has an extra cup and set of syringes in case one is lost or damaged.

Do not use any damaged cups or syringes.

Step 1. Get ready

- Put your child in a safe place. You will need both hands to prepare ISENTRESS.
- Wash your hands with soap and water.
- Take out what you need from the kit as shown below to make 1 dose and place on a clean surface:



1 mixing cup
(Using the tab on the mixing cup, pull open the lid)



1 packet of
ISENTRESS

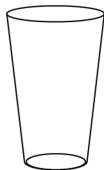

a clean glass

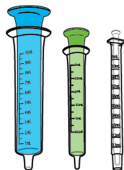

3 syringes

(Have one of each size ready, but you will only need 1 or 2, depending on the prescribed dose)

Step 2. Fill a clean glass with water

Fill a clean glass with room-temperature drinking water from your sink or use bottled water.

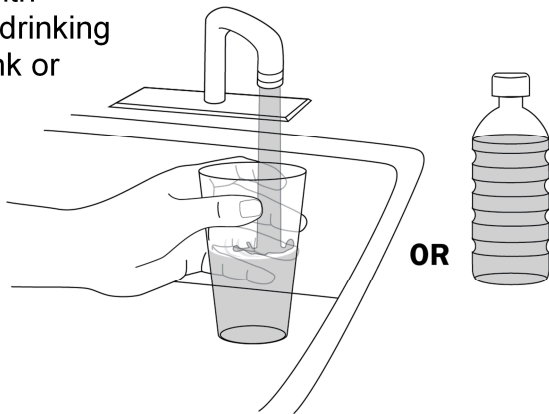

Step 3. Fill the blue syringe with water

Push the plunger of the **blue** syringe into the syringe as far as it goes.

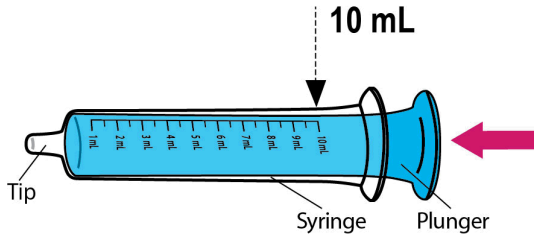

Put the tip of the syringe into the glass of water. Pull back the plunger to draw up water into the syringe. Stop when you get to the 10mL mark.

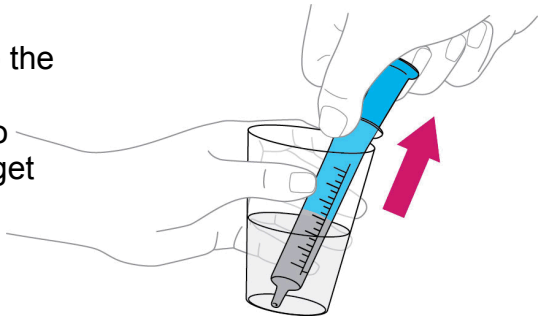

Step 4. Check for air bubbles

Hold the syringe with tip up. Tap it with your finger to move any air bubbles up towards the tip.

Slowly push up on the plunger to make the air come out. You may see some drops of water come out.

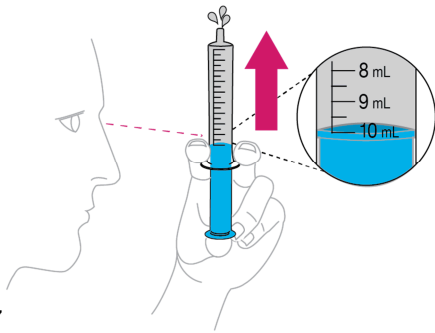
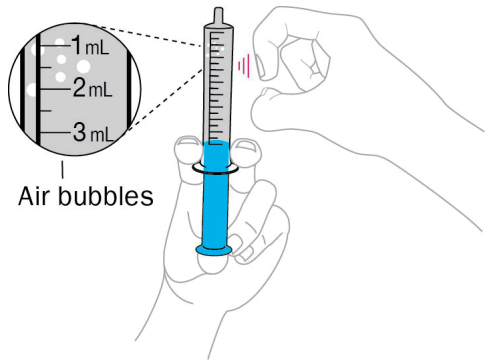

Re-check the amount of water in the syringe. If it is less than 10mL, put the tip back into the water and pull back on the plunger until you get to the 10mL mark.

Step 5. Add the 10mL of water to the mixing cup

Add the 10 mL of water from the syringe to the mixing cup by pushing all the way down on the plunger.

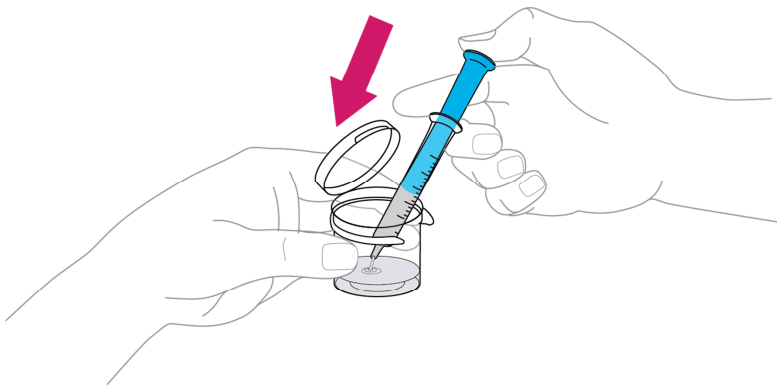

Step 6. Add ISENTRESS to the mixing cup

Note before adding ISENTRESS:

Make sure you and your child are ready! After mixing ISENTRESS, **use it within 30 minutes**. Throw away any leftover ISENTRESS after you have given the dose to your child.

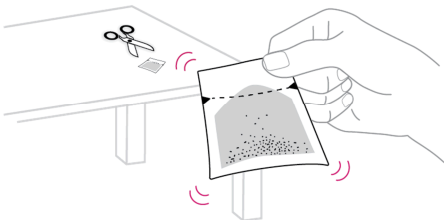

Tear or cut open the packet at the dotted line and add all of the powder to the water in the mixing cup. Make sure the packet is completely empty.

Take 1 packet of ISENTRESS and shake the powder to the bottom of the packet.

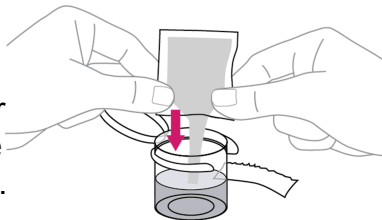

Step 7. Mix ISENTRESS and water

Snap the lid of the mixing cup shut.

Gently swirl the mixing cup for 45 seconds in a circular motion to mix the powder and water. Use a clock or timer to time for 45 seconds.

Do not shake the mixture.

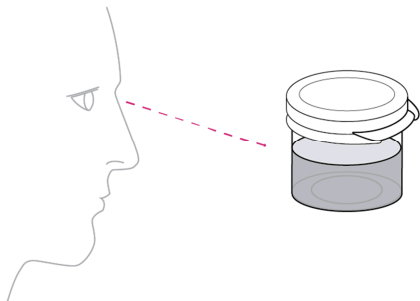
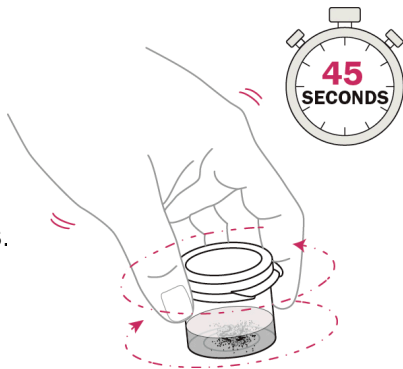

Check to make sure the powder is mixed. If it is not mixed, swirl it some more. The mixture should look cloudy.

Step 8. Check your prescription

Find the dose amount in 'mL' prescribed by your doctor. This is written on the prescription label on the box from your pharmacy.

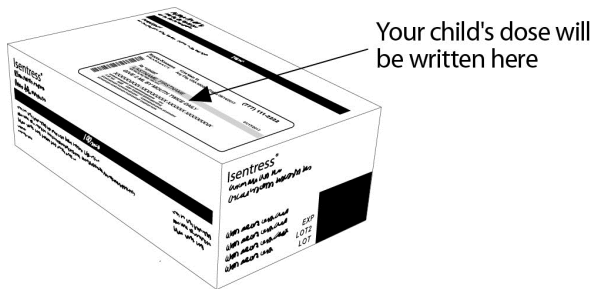

Remember that the dose may change each time you go to the doctor, so make sure you check the prescribed dose each time. Be sure to go to all of your doctor's appointments so your child gets the right dose!

Step 9. Choose the syringe you need

Your doctor will prescribe the dose in milliliters (mL). Choose the right syringe for your child's dose:

WHITE

(1mL)
for **1mL**
or less

Move this part of the
plunger to the right
mark on the syringe

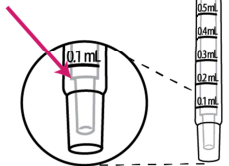

GREEN
(3mL)
for **1.5mL**
to **3mL**

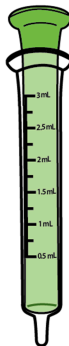

BLUE
(10mL)
for **3.5mL**
to **10mL**

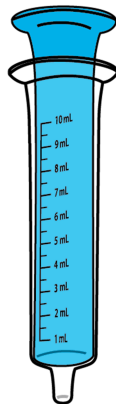

Then find the mL mark on the syringe that matches your child's dose.

Step 10. Measure ISENTRESS

Push the plunger into the barrel of the syringe as far as it goes.

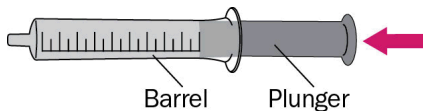

Put the tip of the syringe into the cup of the mixed ISENTRESS and pull back on the plunger.



Stop when you get to the line that matches your child's prescribed dose.

IMPORTANT:

- Your child's dose may be different from the one shown in this figure.
- There will usually be some leftover mixed ISENTRESS in the mixing cup.

Step 11. Check for air bubbles

Hold the syringe with tip up.
Tap it with your finger to move
any air bubbles up towards the
tip.

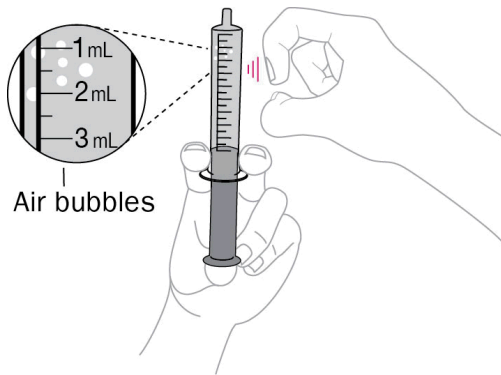

Slowly push the plunger to
make the air come out. You
may see some drops of
medicine come out.

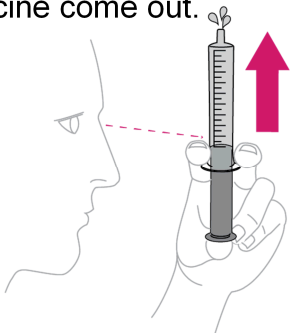

Re-check the amount of ISENTRESS
in the syringe. If it is less than the
prescribed dose, put the tip back
into the cup of mixed ISENTRESS
and pull back on the plunger until you
get to the right dose mark.

Step 12. Give ISENTRESS to your child

Place the tip of the syringe inside your child's mouth so that it touches either the right or left cheek.

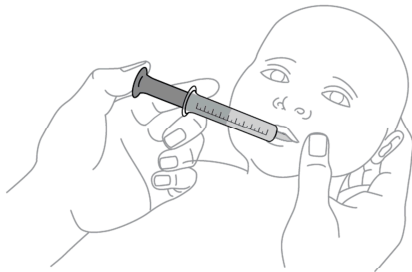

Slowly push in the plunger to give the dose of mixed ISENTRESS to your child. If your child fusses, take the tip of the syringe out of the mouth and try again. It is important that your child takes all of the prescribed dose (a little left in the syringe tip is OK).

IMPORTANT:

If your child does not take all of the prescribed dose or spits some of it out, call your doctor to find out what to do.

Step 13. Clean up

Pour the leftover mixed ISENTRESS into the trash.

Do not pour it into the sink.

Pull the plungers out of any syringes you used.

Hand wash the syringes, plungers, and mixing cup with warm water and dish soap. Do not wash in the dishwasher.

Rinse with water and let air dry.

Put everything in a clean, dry place.

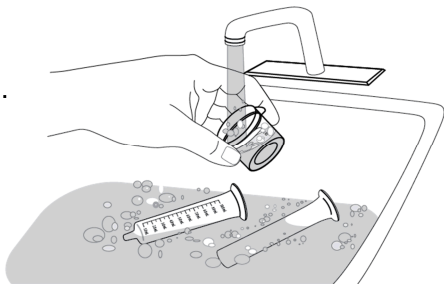

How should I store ISENTRESS?

Store the **ISENTRESS for oral suspension** kit at room temperature between 68°F to 77°F (20°C to 25°C).

Store in the original container.

Keep ISENTRESS and all medicines out of the reach of children.

Be sure to keep your doctor's appointments so you always know how much ISENTRESS to give to your child.

For more information, go to www.ISENTRESS.com or call 1-800-622-4477.

Distributed by:
Merck Sharp & Dohme Corp., a subsidiary of Merck & Co., Inc.
Whitehouse Station, NJ, USA

For patent information: www.merck.com/product/patent/home.html

Copyright © 2013-2017 Merck Sharp & Dohme Corp., a subsidiary of **Merck & Co., Inc.**
All rights reserved.